

FAA STC ST02626CH | EASA STC 03101

Installation of ECS EZMount™ Mechanical Mounting Assemblies on Lower Frames of Cockpit Sliding Windows on Select Airbus A300 Series Aircraft

OVERVIEW

- » FAA STC ST02626CH
- » European Aviation Safety Agency (EASA) STC 03101

Governs the installation of the EZMount mechanical mounting assemblies on lower frames of cockpit sliding windows in accordance with Electronic Cable Specialists (ECS) master data list ECS-206919.

YOUR NEEDS

Provides modernized EFB system mounting provisions for select Airbus A300 series aircraft.

YOUR BENEFITS

Incorporation of STC ST02626CH is required to support separate installation and operational approval of an EFB system in the cockpit. Once installed, the complete EFB system will provide flight crews the ability to interact with electronic maps, charts, and manuals in lieu of accessing standard paper documentation. System installation will reduce materials costs and aircraft weight without compromising ergonomic concerns.

STC AIRCRAFT EFFECTIVITY

- » Airbus A318-111/-112/-121/-122 series aircraft
- » Airbus A319-111/-112/-113/-114/-115/-131/-132/-133 series aircraft
- » Airbus A320-111/-211/-212/-214/-231/-232/-233 series aircraft
- » Airbus A321-111/-112/-131/-211/-212/-213/-231/-232 series aircraft

STC CONFIGURATIONS & LIMITATIONS

- » **Configuration 1:** Installation of two EZMount Tilt mounting assemblies on lower window frame of captain's and first officer's side of cockpit sliding windows.
- » **Configuration 2:** Installation of two EZMount Slider mounting assemblies on lower window frame of captain's and first officer's side of cockpit sliding windows.
- » **Configuration 3:** Installation of two EZMount Pivot mounting assemblies on lower window frame of captain's and first officer's side of cockpit sliding windows.

STC Limitations: None

PRODUCT DESCRIPTION

Three versions of the EZMount mounting arms used for EFB display units are available for installation:

- » **EZMount Tilt:** Refer to Configuration 1 for details.
- » **EZMount Slider:** Refer to Configuration 2 for details.
- » **EZMount Pivot:** Refer to Configuration 3 for details.

Each mounting arm can be installed on the captain's and first officer's side window trims.

ELECTRICAL CHANGES

Configurations 1, 2 & 3:

- » No new wires are added and no existing wires are modified or relocated.

FAA STC ST02626CH | EASA STC 03101

Installation of ECS EZMount™ Mechanical Mounting Assemblies on Lower Frames of Cockpit Sliding Windows on Select Airbus A300 Series Aircraft

MECHANICAL CHANGES

Configuration 1:

- » Modification to the existing captain's side window trim by adding four (4) holes to allow spacers to contact the mounting brackets under window trim, which is attached to the window frame. The mounting plate and EZMount tilt is then installed on the top surface of the spacers. See Figure 1.
- » Modification to the existing first officer's side window trim and installation of EZMount Tilt will be a mirror image of the modification implemented on the captain's side.

FIGURE 1:
Captain's Side Window
Modified With EZMount Tilt
(First Officer's Installation is Mirror Image)

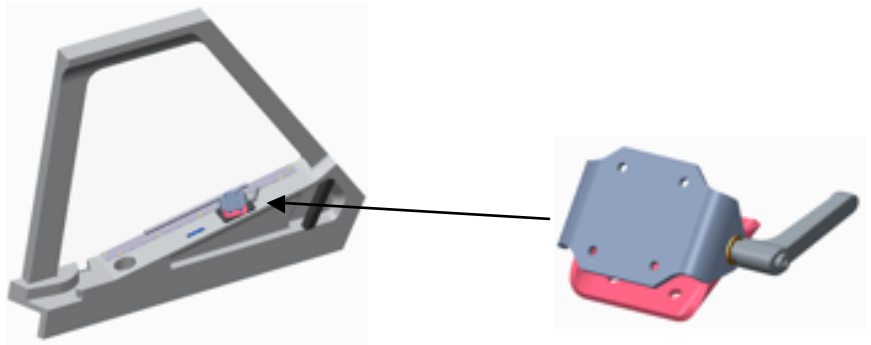

Configuration 2:

- » Modification to the existing captain's side window trim by adding four (4) holes to allow spacers to contact the mounting brackets under window trim that are attached to the window frame. The mounting plate assembly and EZMount Slider is then installed on the top surface of the spacers. See Figure 2.
- » Modification to the existing first officer's side window trim and installation of EZMount Slider will be a mirror image of the modification implemented on the captain's side.

FIGURE 2:
Captain's Side Window
Modified With EZMount Slider
(First Officer's Installation is Mirror Image)

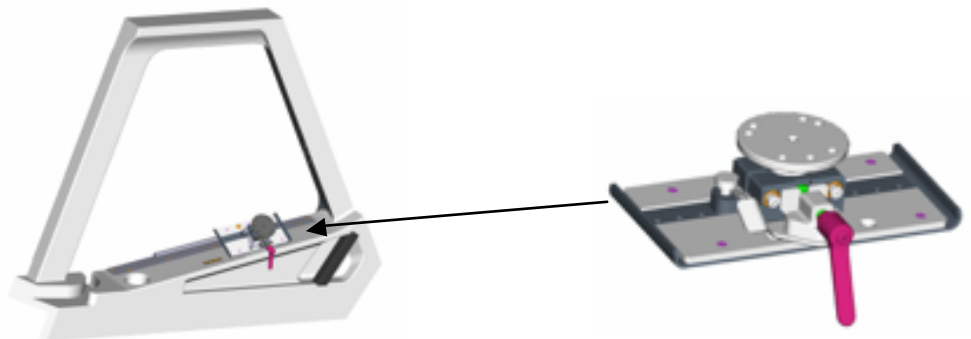

FAA STC ST02626CH | EASA STC 03101

Installation of ECS EZMount™ Mechanical Mounting Assemblies on Lower Frames of Cockpit Sliding Windows on Select Airbus A300 Series Aircraft

Configuration 3:

- » Modification to the existing captain's side window trim by adding four (4) holes to allow spacers to contact the mounting brackets under window trim that are attached to the window frame. The mounting plate assembly and EZMount Pivot is then installed on the top surface of the spacers. See Figure 3.
- » Modification to the existing first officer's side window trim and installation of EZMount Pivot will be a mirror image of the modification implemented on the captain's side.

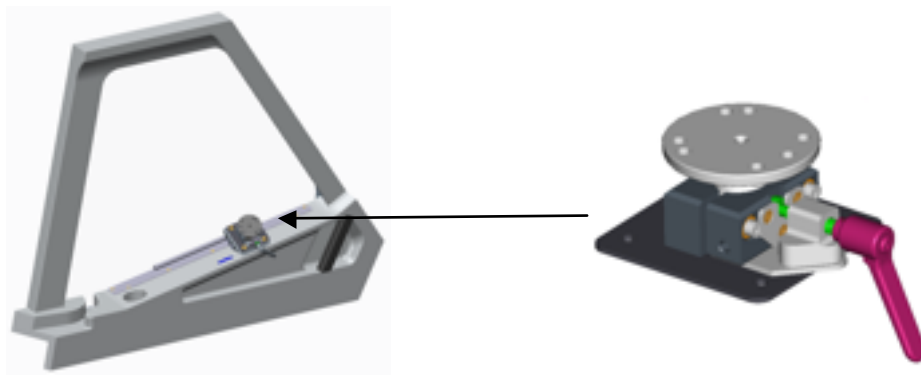

FIGURE 3:
Captain's Side Window
Modified With EZMount Pivot
(First Officer's Installation is Mirror Image)